

the westin beach resort, fort lauderdale

opening early 2009:

the westin beach resort, fort lauderdale
321 north fort lauderdale beach boulevard (a1a)
fort lauderdale, florida 33304
t 954.467.1111 f 954.462.2342
westin.com/fortlauderdalebeach

pre-opening sales office:

1140 seabreeze boulevard, fort lauderdale, florida 33316
t 800.823.2240 f 954.467.0100
contact: fortlauderdalebeach@westin.com

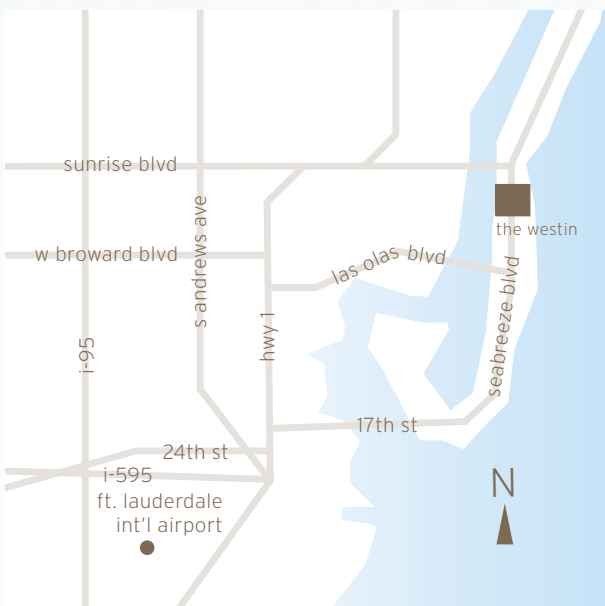

guest accommodations

Each of the resort's 433 spacious guestrooms and suites will offer the Heavenly® Bed, the Heavenly® Bath, dual-line phones, voice mail, high-speed Internet access, a refreshment center, a 32-inch flat-panel TV, and in-room movies. Most guest accommodations will provide revitalizing views of the Atlantic Ocean or the Intracoastal Waterway.

facilities and services

The resort's 8,100-square-foot Heavenly® Spa and 24-hour WestinWORKOUT® fitness center will feature cardiovascular equipment, weight machines, a cardio theater, and a large outdoor pool with beach views and a palm-lined sun deck. The spa will offer soothing therapies and locally inspired products.

Wireless Internet service will be available in all guestrooms and suites, meeting spaces, restaurants and public areas, and on the pool's sun deck.

An attentive concierge staff will assist guests with making arrangements at nearby golf courses and for sightseeing, deep-sea fishing, scuba diving, sailing, and other activities.

Additional services include valet parking and The Westin Kids ClubSM with fun activities, amenities, and programs for young guests ages 4 to 12.

dining

Recognized as one of America's top 10 steak houses, Shula's on the Beach will offer guests a unique, memorable dining experience.

Waves Bar and Grill will provide an ideal poolside location where guests can enjoy tropical drinks, light bites, warm sun, and the company of friends.

Fresh-brewed coffee, pastries, and to-go items will also be offered in the resort's full-service Starbucks®.

In-room dining will be available 24 hours daily.

meeting & catering services

Perfectly suited for special social occasions and private business events, the resort will offer more than 32,000 square feet of meeting and event space, including outdoor venues, as well as ample prefunction space. All of the resort's meeting and event space is being designed so it may be arranged in a variety of configurations to best suit an array of needs. The 10,192-square-foot Las Olas Ballroom, featuring a dramatic 20-foot-high ceiling, and the elegant 8,376-square-foot Atlantic Ballroom are ideal for large-scale affairs. A wide range of audiovisual and technology services will also be offered.

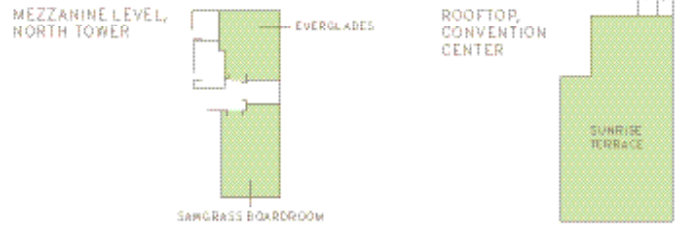
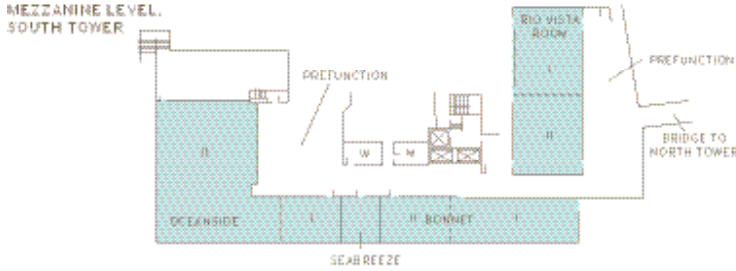
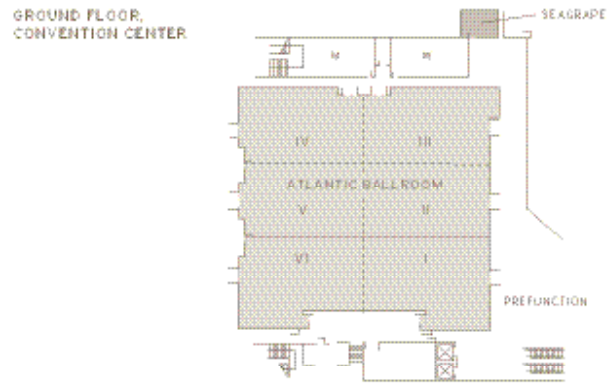
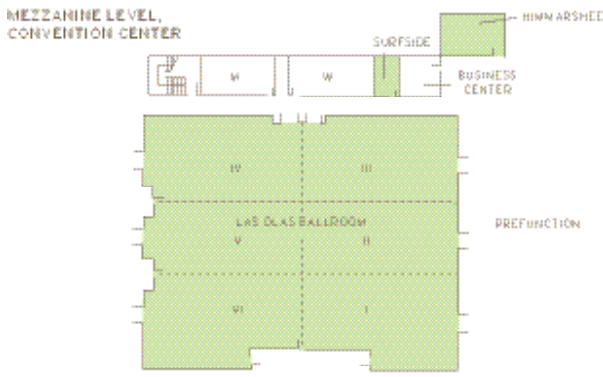

ROOM NAME	DIMENSIONS	SQUARE FEET	CEILING	ROUNDS	THEATER	CLASSROOM	RECEPTION	H-SQUARE	CONFERENCE	8' X 10'
MEZZANINE LEVEL, CONVENTION CENTER										
LAS OLAS BALLROOM	119' X 91'	10,192	20'	690	900	500	1,053	-	-	52
LAS OLAS I	59' X 33'	1,707	20'	120	150	63	180	40	32	-
LAS OLAS II	57' X 26'	1,437	20'	110	150	63	150	40	32	-
LAS OLAS III	59' X 27'	1,636	20'	120	150	63	170	40	32	-
LAS OLAS IV	59' X 27'	1,591	20'	120	150	63	170	40	32	-
LAS OLAS V	56' X 26'	1,430	20'	110	150	63	150	40	32	-
LAS OLAS VI	60' X 26'	1,762	20'	120	150	63	185	40	32	-
LAS OLAS I, II, III	59' X 91'	4,795	20'	320	500	225	485	-	-	25
LAS OLAS IV, V, VI	59' X 91'	4,790	20'	320	500	225	485	-	-	25
LAS OLAS I, II	59' X 60'	3,157	20'	230	336	135	320	-	-	16
LAS OLAS II, III	59' X 57'	3,068	20'	230	336	135	320	-	-	16
LAS OLAS IV, V	59' X 57'	3,027	20'	230	336	135	320	-	-	16
LAS OLAS V, VI	59' X 60'	3,194	20'	230	336	135	330	-	-	16
LAS OLAS I, II, V, VI	119' X 60'	6,351	20'	400	676	300	675	-	-	36
LAS OLAS II, III, IV, V	119' X 57'	6,096	20'	400	676	300	650	-	-	36
HIMMARSHEE	37' X 24'	869	14'	60	88	50	89	28	24	-
SURFSIDE	-	-	-	-	-	-	-	-	-	-
GROUND FLOOR, CONVENTION CENTER										
ATLANTIC BALLROOM	101' X 91'	8,376	14'	580	874	450	842	-	-	44
ATLANTIC I	51' X 33'	1,480	14'	90	132	56	150	36	28	-
ATLANTIC II	50' X 28'	1,349	14'	90	132	56	140	36	28	-
ATLANTIC III	51' X 31'	1,447	14'	90	132	56	150	36	28	-
ATLANTIC IV	51' X 31'	1,398	14'	90	132	56	150	36	28	-
ATLANTIC V	48' X 27'	1,273	14'	90	132	56	130	36	28	-
ATLANTIC VI	51' X 33'	1,432	14'	90	132	56	150	36	28	-
ATLANTIC I, II, III	51' X 91	4,284	14'	290	400	210	450	-	-	19
ATLANTIC IV, V, VI	51' X 91'	4,091	14'	290	400	210	420	-	-	19
ATLANTIC I, II	51' X 61'	2,840	14'	200	280	120	295	-	-	14
ATLANTIC II, III	51' X 58'	2,804	14'	200	280	120	295	-	-	14
ATLANTIC IV, V	51' X 58'	2,660	14'	200	280	120	275	-	-	14
ATLANTIC V, VI	51' X 61'	2,695	14'	200	280	120	275	-	-	14
ATLANTIC I, II, V, VI	101' X 61'	5,535	14'	350	550	255	580	-	-	30
ATLANTIC II, III, IV, V	101' X 61'	5,535	14'	350	550	255	580	-	-	30
SEAGRAPE	-	-	-	-	-	-	-	-	-	-
MEZZANINE LEVEL, SOUTH TOWER										
OCEANSIDE	IRREGULAR	2,687	10'10"	190	-	-	250	-	-	-
OCEANSIDE I	20' X 44'	515	10'10"	30	28	12	40	12	12	-
OCEANSIDE II	39' X 64'	2,172	10'10"	160	196	114	220	60	-	-
SEABREEZE	21' X 11'	224	10'10"	-	-	-	-	-	10	-
BONNET	20' X 68'	1,364	10'10"	90	112	50	100	36	30	-
BONNET I	20' X 44'	885	10'10"	60	63	28	60	20	20	-
BONNET II	20' X 24'	479	10'10"	30	28	12	20	12	12	-
RIO VISTA	27' X 52'	1,338	10'10"	100	120	51	120	30	28	-
RIO VISTA I	27' X 26'	695	10'10"	40	50	24	60	16	16	-
RIO VISTA II	27' X 26'	643	10'10"	40	50	24	60	16	16	-
MEZZANINE LEVEL, NORTH TOWER										
EVERGLADES	25' X 20'	470	9'	-	-	-	-	-	14	-
SAWGRASS BOARDROOM	30' X 19'	530	9'	-	-	-	-	-	16	-
ROOFTOP, CONVENTION CENTER										
SUNRISE TERRACE	-	5,536	-	340	-	-	550	-	-	-